

OUTDOOR ALUMINUM VENETIAN BLINDS



BSO

The adjustable slats allow for precise solar management, integrate into the building's façade and reduce the thermal load, contributing to energy savings.

They are made of non-rusting materials, ensuring maximum durability and outdoor resistance.

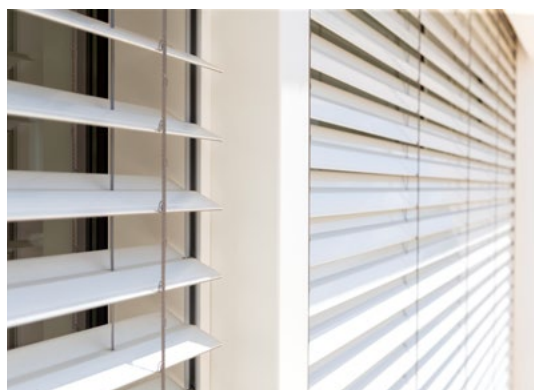

OUTDOOR ALUMINUM VENETIAN BLINDS



					
	Z70 / Z90	C80	F80	C50+	C50
Maximum width	5000 mm		4500 mm	3000 mm	
Maximum height	5000 mm			3500 mm	2500 mm
Maximum surface	20 m²		8 m²		5 m²
Installation	Ceiling / Wall				
Composition	100% AL				
Slat thickness	0,45 mm			0,28 mm	
Slat widths	70 - 90 mm	80 mm		50 mm	
Section	"Z" (Rigid and strong wind resistance)	"C" (Reinforced at the ends)	"C" (Flexible)		
Operating system	Crank / Motor				Cord
Options	U-shaped aluminum guide Self-supporting rectangular guide Circular guide Cable guide (Not available for Z70 and Z90) Cover plate Connected blinds (Max. 3 blinds)			Cable guide Cover plate Connected blinds (Max. 3 blinds)	Cable guide Cover plate

PRODUCT PRESENTATION

OUTDOOR ALUMINUM VENETIAN BLINDS BSO

Optimal light management

Thanks to the adjustable inclination of the slats, they can be adapted to all angles of sunlight. In addition, home automation systems can be used, which automatically adjust to the direction of sunligh at any time of the year, thus achieving perfect lighting comfort at all times.

Energy saving

We can achieve energy savings of up to 10%. This sunlight management system efficiently manages the light and heat that enters through the building's windows. BSO from Bandalux improves the energy classification of a building, as required by the CTE (Calendar GT) or LEED certification.

High durability and resistance

The Bandalux BSO is highly resistant to adverse weather conditions. All its components and its motor (with IP54 protection rating) are corrosion-resistant and guarantee high durability when installed outdoors, capable of resisting winds of up to 76 km/h*.

In models Z-90 and Z-70
(class 5, maximum according to EN 13659).

Versatility and aesthetics

The slats can be completely retracted under the headrail, offering total integration into the building's façade, like a second skin. Different types of slats, headrail with different cover plate options and a wide range of colours available, among other options, allow us to configure the Venetian blind according to the needs and aesthetics of the building.

Perfect working conditions

With this heating and lighting management system you can achieve perfect working conditions, allowing incoming light to be managed while also achieving good external visibility.

PRODUCT PRESENTATION

OUTDOOR ALUMINUM VENETIAN BLINDS BSO

Cover plates

The headrail and slats can be covered with a lacquered aluminium cover plate. Depending on the model, the cover plate is 1,5 mm or 2 mm thick and its height varies depending on the stacking height. In the case of front installation, side covers are incorporated and fixed with rivets.

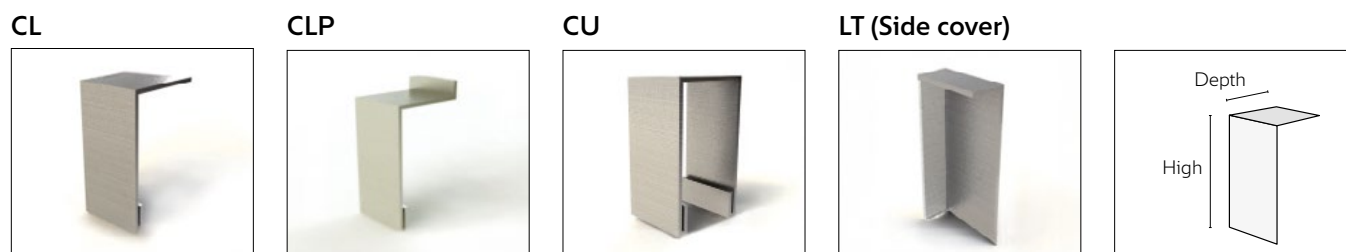

Headrail

All models include a 0,65 mm thick galvanized steel headrail where the guiding and lifting mechanisms are installed.

56x58



40x40



Slats

Z70

Rigid and strong
wind resistance

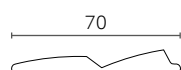

Z90

Rigid and strong
wind resistance

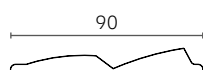

C80

Reinforced
at the ends

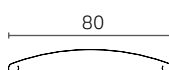

F80

Flexible

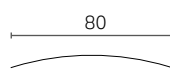

C50+

Flexible

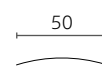

C50

Flexible

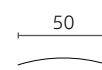

Bottom bar

Each model includes an aluminum bottom bar adapted to the geometry of the slats.

Z70 - Z90

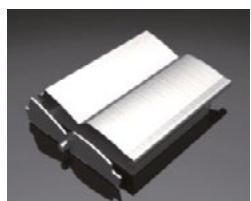

C80

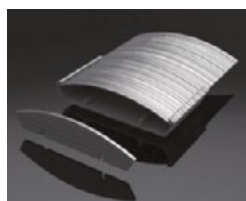

F80

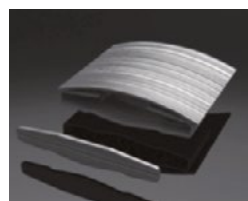

C50 - C50+

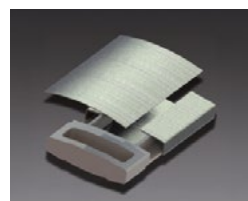

PRODUCT PRESENTATION

OUTDOOR ALUMINUM VENETIAN BLINDS BSO

Slat colours

More than 20 different colors available, depending on the chosen slat type. The BSO outdoor Venetian blind also provides the same color for the slats, guides, bottom bar and hiding cover plate, ensuring that it perfectly integrates into the design of the building.

❗ The headrail will not be supplied lacquered.

	Z70	Z90	C80	F80	C50+	C50
 Antracita RAL 7016	✓	✓	✓	✓	✓	✓
 Antracita Matt RAL 7016 M	-	✓	✓	-	-	-
 Basalt Grey RAL 7012	✓	✓	✓	✓	-	-
 Black Grey RAL 7021	-	✓	✓	-	-	-
 Black Matt RAL 9005 M	✓	✓	✓	✓	-	-
 Bronze Dark VSR 780 D	-	✓	✓	-	-	-
 Bronze Light VSR 780 H	✓	✓	✓	-	-	-
 Brown RAL 8028	✓	✓	✓	-	-	-
 Creamy RAL 9001	-	✓	✓	-	-	-
 Dark Green RAL 6005	-	-	-	-	✓	✓
 Dark Grey DB 703	✓	✓	✓	✓	✓	✓
 Grey RAL 7022	✓	✓	✓	✓	-	-
 Grey RAL 7038	✓	✓	✓	-	✓	✓
 Grey Silver RAL 9007	✓	✓	✓	✓	✓	✓
 Grey White RAL 9002	-	✓	✓	-	-	-
 Ivory RAL 1013	-	✓	✓	-	✓	✓
 Light Beige VSR 240	✓	✓	✓	-	-	-
 Light Grey RAL 7035	-	✓	✓	-	✓	✓
 Silver RAL 9006	✓	✓	✓	✓	✓	✓
 Silver Texture RAL 9006 ⁽¹⁾	✓	✓	✓	✓	-	-
 Quartz Grey RAL 7039	-	✓	✓	-	-	-
 White RAL 9003	✓	✓	✓	✓	-	-
 White RAL 9010	✓	✓	✓	✓	-	-
 White RAL 9016	-	-	-	-	✓	✓

❗ (1) Textured slats

PRODUCT PRESENTATION

OUTDOOR ALUMINUM VENETIAN BLINDS BSO

Side guides

The BSO includes a highly resistant guiding track and a system that prevents noise and vibrations between parts.

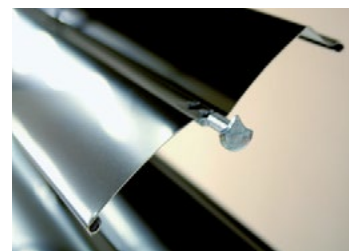

Side guides 'U'-shaped

Made from extruded aluminum and coated in the same color as the slats. They are installed directly to the wall and allows side installation.



GUP

GUE

GUD

Rectangular section self-supporting guides

Self-supporting system with 40x20 mm rectangular section guides, with its own telescopic spacers.



GAPR

Circular section guides

Circular section self-supporting systems with guides; can be standard or double ($\varnothing = 41$ mm).

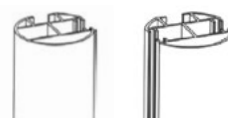

GAPCS

GAPCD

Spacer brackets

The U-shaped guides allow you to use spacer brackets for wall installations and spacing.

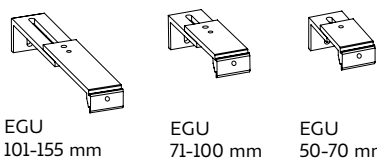

EGU
101-155 mm

EGU
71-100 mm

EGU
50-70 mm

Telescopic spacers

They are included in both the self-supporting guide systems and allow you to space the guides from the façade to the desired distance.



SGU
50-70 mm

SGU
71-105 mm

SGU
106-170 mm



SAP
55-75 mm



SAP
75-120 mm

Cable guides and tensioners

All systems, except Z70 and Z90, offer the option of being guided by a $\varnothing 2.2$ mm diameter galvanised braided steel cable covered with PVC.

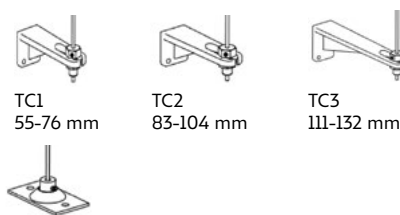

TC1
55-76 mm

TC2
83-104 mm

TC3
111-132 mm

TS - FLOOR FASTENING

Number of guide supports (brackets, telescopic spacers and cable tensioners)

Height BSO (mm)	Z70	Z90	C80	F80	C50+	C50
Up to 1600		2			2	2
From 1610 to 2600		3			3	3
From 2610 to 4000		4			4	-
From 4000 to 5000		5			-	-

Number of headrail supports

Width BSO (mm)	Z70	Z90	C80	F80	Width BSO (mm)	C50+	Width BSO (mm)	C50
Up to 1400		2			Up to 1400	2	Up to 1100	2
From 1410 to 2400		3			From 1410 to 1900	3	From 1110 to 2200	3
From 2410 to 3400		4			From 1910 to 2900	4	From 2210 to 2500	4
From 3410 to 5000		5			From 2910 to 3000	5		

TECHNICAL DATA

OUTDOOR ALUMINUM VENETIAN BLINDS BSO

Maximum dimensions

		Z70	Z90	C80	F80	C50+	C50	
Blinds in standard configuration (cable guide, aluminium guide)	Maximum width	Cord	-				2500 mm	
		Crank	5000 mm			4500 mm	3000 mm	-
		Motor						
	Maximum height	Cord	-				2500 mm	
		Crank	5000 mm				3500 mm	-
		Motor						
	Maximum surface	Cord	-				5 m²	
		Crank	8 m²				-	
		Motor	20 m²			9 m²		
With self-supporting guides	Maximum width	Crank	2500 mm				-	
		Motor						
	Maximum height	Crank	4000 mm					
		Motor						
	Maximum surface	Crank	8 m²					
		Motor	10 m²					
Connected blinds ⁽¹⁾ (Side operation)	Maximum width	Crank	6000 mm				-	
		Motor						
	Maximum surface	Crank	8 m²					
Motor		34 m²			27 m²			
Connected blinds ⁽¹⁾ (Central operation)	Maximum width	Crank	12000 mm				-	
		Motor						
	Maximum surface	Crank	8 m²					
		Motor	34 m²			27 m²		

(1) Maximum 3 connections.

TECHNICAL DATA

OUTDOOR ALUMINUM VENETIAN BLINDS BSO

Operating systems

		Z70	Z90	C80	F80	C50+	C50
Cord				-			✓
Crank (Fixed or removable)	With 45° return			✓			-
	With 90° return			✓			-
	Outdoor without return			✓			-
Motor	Somfy® Hardwired			✓			-
	Somfy® IO			✓			-

Controls height (crank)

The requested hand crank height will be considered with the hand crank extended (H1). The hand crank height in operating position is $H2 = H1 - 24\text{cm}$

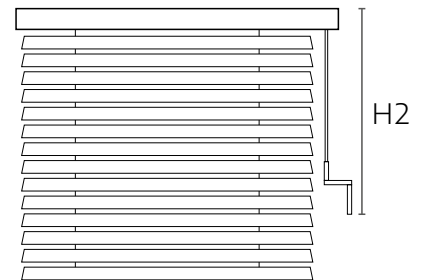
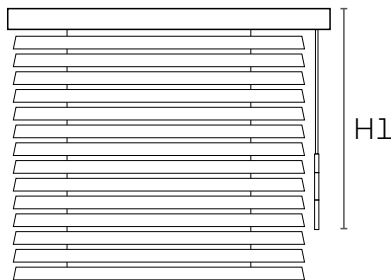

Motorization

Motors with Hirshmann connection. Supplied with 50 cm of cable as standard.

	6 Nm	10 Nm	18 Nm
Voltage	230 V / 50 Hz		
Protection	IP54		
Operational temperature	-10 °C a +85 °C		
Speed	24 rpm		
Maximum operational time	Maximum 6 minutes		
Intensity (A)	0,41	0,51	0,70
Length (mm)	254	269	289

ⓘ The configuration can be completed with sensors and automated components from Bandalux.

TECHNICAL DATA

OUTDOOR ALUMINUM VENETIAN BLINDS BSO

Lifting straps

The lift and descent is performed using Texband® strap (high-tenacity PES) 8 mm thick (6 mm for C50+ and C50).

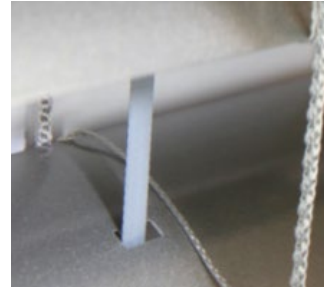

Number of tapes and string adders

Height BSO (mm)	Up to 2500	From 2510 to 3000	From 3010 to 4000	Number of tapes and string adders Z70 / Z90 / C80 / F80 / C50+ / C50
Width BSO (mm)	Up to 1400	Up to 1300	Up to 1200	2
	From 1410 to 2400	From 1310 to 2200	From 1210 to 2000	3
	From 2410 to 3400	From 2210 to 3100	From 2010 to 2800	4
	From 3410 to 4000	From 3110 to 4000	From 2810 to 4000	5

Stacking height (Hr)

	Z70		Z90		C80		F80	
Height BSO (mm)								
Up to 750	150	170	120	140	140	160	115	135
From 750 to 1000	160	180	140	160	160	180	125	145
From 1010 to 1250	170	190	150	170	180	200	130	150
From 1260 to 1500	190	210	160	180	200	220	140	160
From 1510 to 1750	210	230	180	200	220	240	145	165
From 1760 to 2000	230	250	190	210	240	260	155	175
From 2010 to 2250	250	270	200	220	260	280	160	180
From 2260 to 2500	270	290	220	240	280	300	170	190
From 2510 to 2750	280	300	230	250	300	320	175	195
From 2760 to 3000	290	310	240	260	320	340	185	205
From 3010 to 3250	310	330	250	270	340	360	190	210
From 3260 to 3500	330	350	270	280	360	380	200	220
From 3510 to 3750	350	370	280	300	380	400	205	225
From 3760 to 4000	370	390	290	310	400	420	210	230
From 4010 to 4250	380	400	300	320	420	440	220	240
From 4260 to 4500	400	420	310	330	440	460	230	250
From 4510 to 4750	410	430	330	350	460	480	235	255
From 4760 to 5000	430	450	340	360	480	500	245	265

	C50+	C50
Height BSO (mm)		
Up to 1000	135	95
From 1010 to 1500	150	110
From 1510 to 2000	160	120
From 2010 to 2500	175	135
From 2510 to 3000	190	-
From 3010 to 3500	205	-

Cover plate height (Hc)

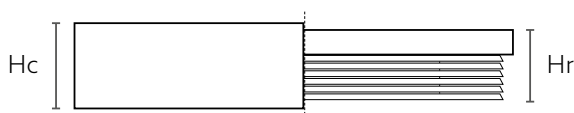

❗ The cover plate height (Hc) shall be 10 mm upper than the stacking height (Hr).

TECHNICAL DATA

OUTDOOR ALUMINUM VENETIAN BLINDS BSO

Side guide dimensions (mm)

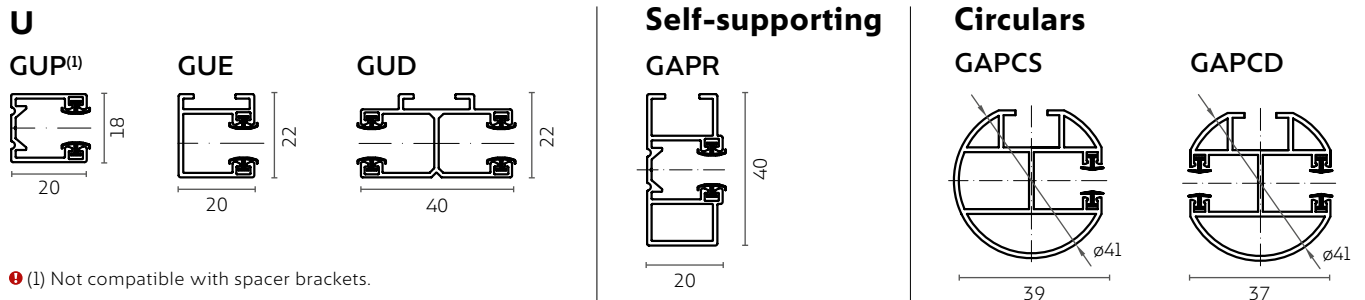

Dimensions of spacer brackets and telescopic spacers (mm)

With side guides GUE and GUD

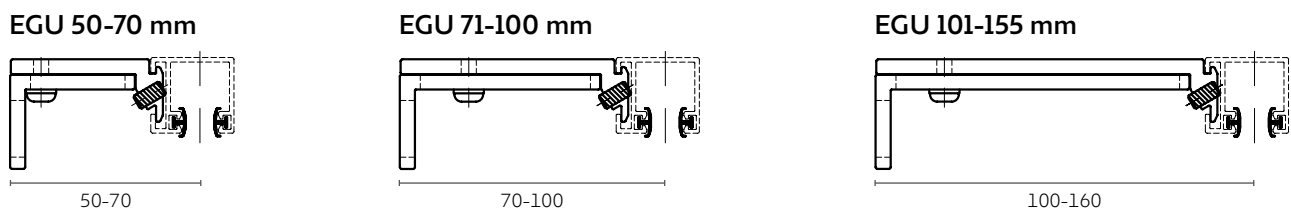

With side guides GUE, GUD, GAPCS and GAPCD

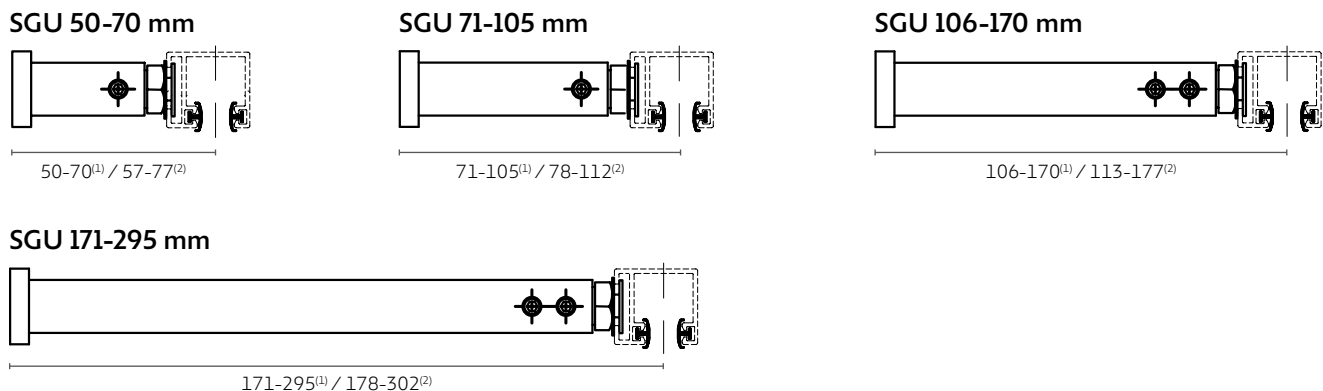

❗ (1) Measures for guides GUE and GUD. / (2) Measures for guides GAPCS and GAPCD.

With self-supporting guide GAPR

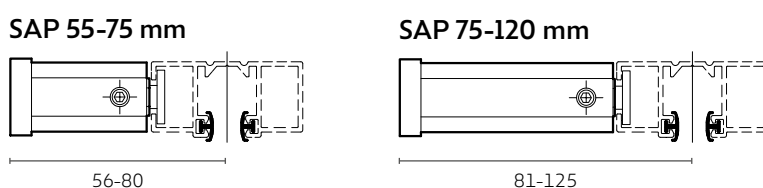

TECHNICAL DATA

OUTDOOR ALUMINUM VENETIAN BLINDS BSO

Cable tensioner dimensions (mm)

TC0 mm wall

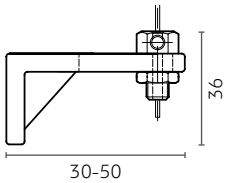

TC1 - TC2 - TC3 wall

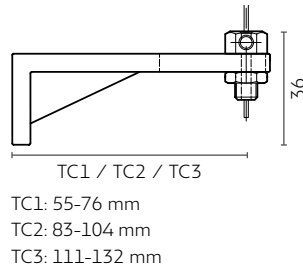

TS SFloor fastening

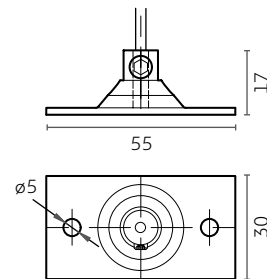

Dimensions of ceiling bracket for headrail (mm)

Headrail 56x58 mm

ST 56x58

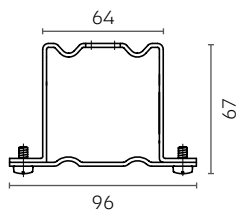

❗ Not available for C50.

Headrail 40x40 mm

ST 40x40

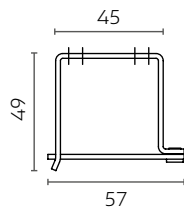

❗ Only available for C50.

Dimensions of wall bracket for headrail (mm)

Headrail 56x58 mm

EL 40 mm

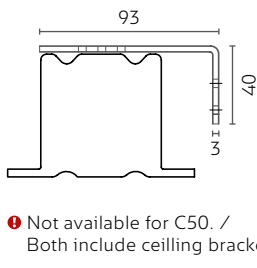

❗ Not available for C50. /
Both include ceiling bracket ST 56x58.

EL 100 mm

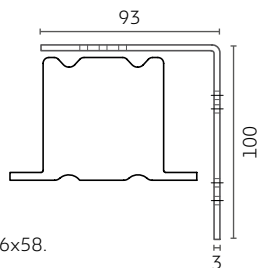

Headrail 40x40 mm

EL 49 mm

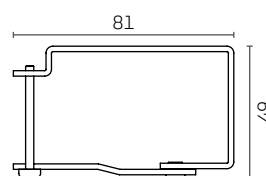

❗ Only available for C50.

TECHNICAL DATA

OUTDOOR ALUMINUM VENETIAN BLINDS BSO

Dimensions of ceiling/wall bracket + cover plate (mm)

Headrail 56x58 mm

ELC 120 mm

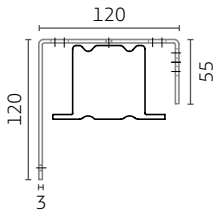

❗ Only available for Z70, C80 and F80.

ELC 140 mm

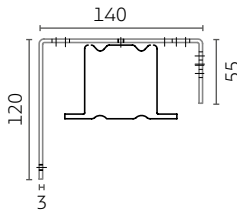

❗ Only available for Z90.

ELCT 100-150 mm

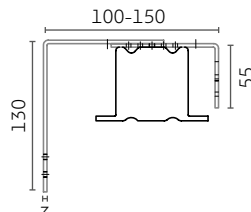

ELCT 150-200 mm

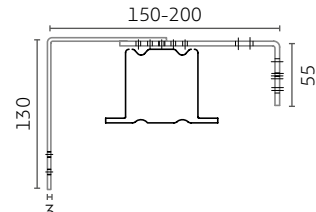

Headrail 40x40 mm

ELC 87 mm

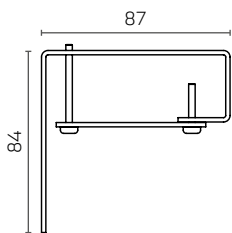

❗ Only available for C50.

OPTIONS

OUTDOOR ALUMINUM VENETIAN BLINDS BSO

Operating systems

		Z70	Z90	C80	F80	C50+	C50
Cord				-			✓
Fixed crank with 45° return				✓			-
Fixed crank with 90° return				✓			-
Removable crank with 45° return				✓			-
Removable crank with 90° return				✓			-
Fixed crank without return				✓			-
Removable crank without return				✓			-
Motor operating system	Somfy® Hardwired		✓			✓	-
	Somfy® IO		✓			✓	-

❗ (1) Provided by default.

Connected blinds⁽¹⁾

		Z70	Z90	C80	F80	C50+	C50
Connected blinds				✓			

❗ (1) Maximum 3 connections.

Cover plates⁽¹⁾

		Z70	Z90	C80	F80	C50+	C50
Cover plates	CL			✓			
	CLP		✓				-
	CU		✓				-
Side cover for cover plate (LT)				✓			

❗ (1) Cover plate longer than 3500 mm will be provided in two parts.

OPTIONS

OUTDOOR ALUMINUM VENETIAN BLINDS BSO

Aluminium side guides

		Z70	Z90	C80	F80	C50+	C50
Guides "U"	GUE			✓			-
	GUP			✓			-
	GUD			✓			-
Self-supporting rectangular guide	GAPR			✓			-
Circular guide	GAPCD			✓			-
	GAPCS			✓			-

❗ (1) Provided by default.

Spacer brackets and telescopic spacers Z70 / Z90 / C80 / F80

		4 brackets	6 brackets	8 brackets
Blind height measurement		Up to 1600 mm	1610-2600 mm	2610-5000 mm
Spacer brackets for guides GUE and GUD	EGU 50-70	✓	✓	✓
	EGU 71-100	✓	✓	✓
	EGU 101-150	✓	✓	✓
Telescopic spacers for guides GUE, GUD, GAPCS and GAPCD	SGU 50-70	✓	✓	✓
	SGU 71-105	✓	✓	✓
	SGU 106-170	✓	✓	✓
	SGU 175-295	✓	✓	✓
Telescopic spacers for guides GAPR	SAP 55-75	✓	✓	✓
	SAP 75-120	✓	✓	✓

❗ (1) Provided by default.

Cable guide

		Z70	Z90	C80	F80	C50+	C50
Guide	Cable 2,2 mm	-		✓		✓	
Cable tensioner (2 brackets)	TC0 30-50	-		✓		✓	
	TC1 55-76	-		✓		✓	
	TC2 83-104	-		✓		✓	
	TC3 111-132	-		✓		✓	
	TS Floor fastening	-		✓		✓	

❗ (1) Provided by default.

OPTIONS

OUTDOOR ALUMINUM VENETIAN BLINDS BSO

Headrail and cover plate brackets Z70 / Z90 / C80 / F80

	2 brackets	3 brackets	4 brackets	5 brackets
Blind width measurement >	Up to 1400 mm	1410-2400 mm	2410-3400 mm	3410-5000 mm
Ceiling bracket ST 56 x 58 mm	✓	✓	✓	✓
Wall bracket EL 40 mm	✓	✓	✓	✓
Wall bracket EL 100 mm	✓	✓	✓	✓
Cover plate bracket ELC 120 mm	✓	✓	✓	✓
Cover plate bracket ELC 140 mm	✓	✓	✓	✓
Cover plate bracket ELCT 100-150	✓	✓	✓	✓
Cover plate bracket ELCT 150-200	✓	✓	✓	✓

Headrail and cover plate brackets C50+

	2 brackets	3 brackets	4 brackets	5 brackets
Blind width measurement >	Up to 1400 mm	1410-1900 mm	1910-2900 mm	2910-3000 mm
Ceiling bracket ST 56 x 58 mm	✓	✓	✓	✓
Wall bracket EL 40 mm	✓	✓	✓	✓
Wall bracket EL 100 mm	✓	✓	✓	✓
Cover plate bracket ELC 120 mm	✓	✓	✓	✓
Cover plate bracket ELC 140 mm	✓	✓	✓	✓
Cover plate bracket ELCT 100-150	✓	✓	✓	✓
Cover plate bracket ELCT 150-200	✓	✓	✓	✓

Headrail and cover plate brackets C50

	2 brackets	3 brackets	4 brackets
Blind width measurement >	Up to 1100 mm	1110-2200 mm	2210-2500 mm
Ceiling bracket ST 40 x 40 mm	✓	✓	✓
Wall bracket EL 49 mm	✓	✓	✓
Cover plate bracket ELC 87	✓	✓	✓

❗ (1) Provided by default.

SPARE PARTS

OUTDOOR ALUMINUM VENETIAN BLINDS BSO

MODELS

Z70 | Z90 | C80 | F80

WITH CRANK AND 'U' GUIDE

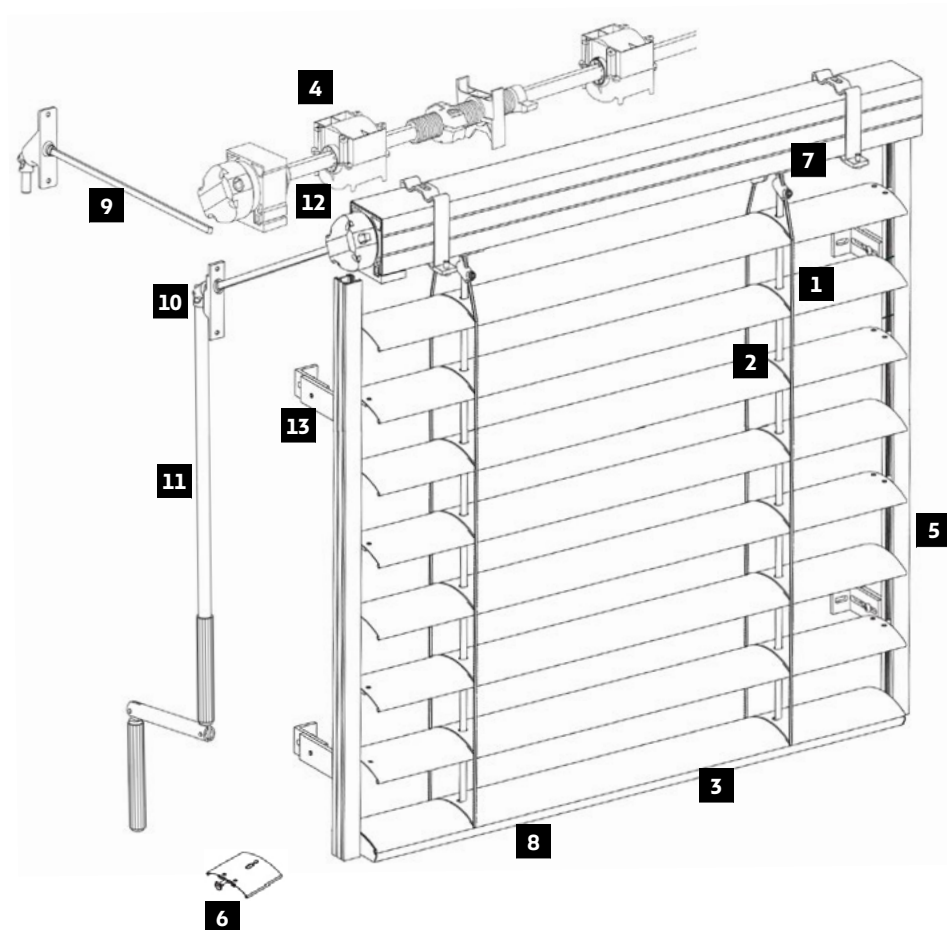

1	Ladder
2	Lifting strap
3	Bottom bar
4	Drum
5	Side guide
6	Guiding track
7	Ladder clip

8	End cap bottom bar
9	90° crank return
10	45° crank return
11	Crank
12	Crank device
13	Bracket spacer

MODELS

Z70 | Z90 | C80 | F80 | C50+

WITH MOTOR AND CABLE GUIDE

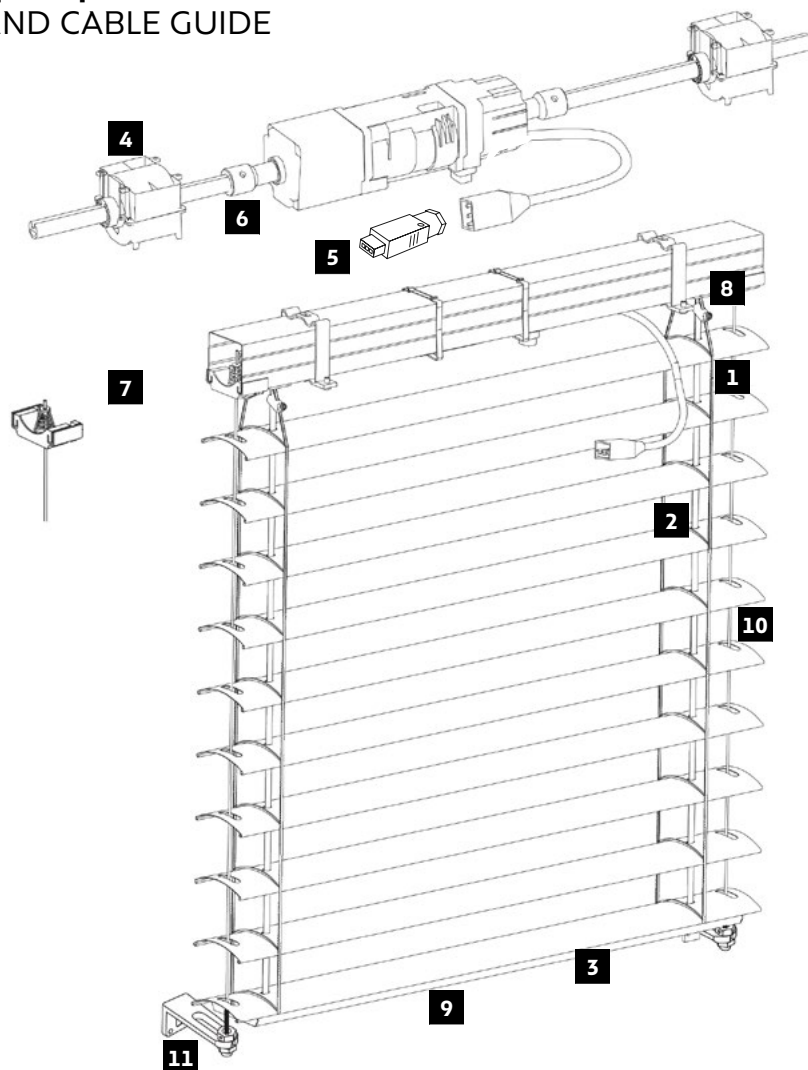

1	Ladder
2	Lifting strap
3	Bottom bar
4	Drum
5	Hirschmann connector
6	Motor to shaft adapter

7	Guided cable headrail bracket
8	Ladder clip
9	End cap bottom bar
10	Guided cable
11	Cable tensioner

SPARE PARTS

OUTDOOR ALUMINUM VENETIAN BLINDS BSO

MODEL
C50+
WITH CRANK / MOTOR

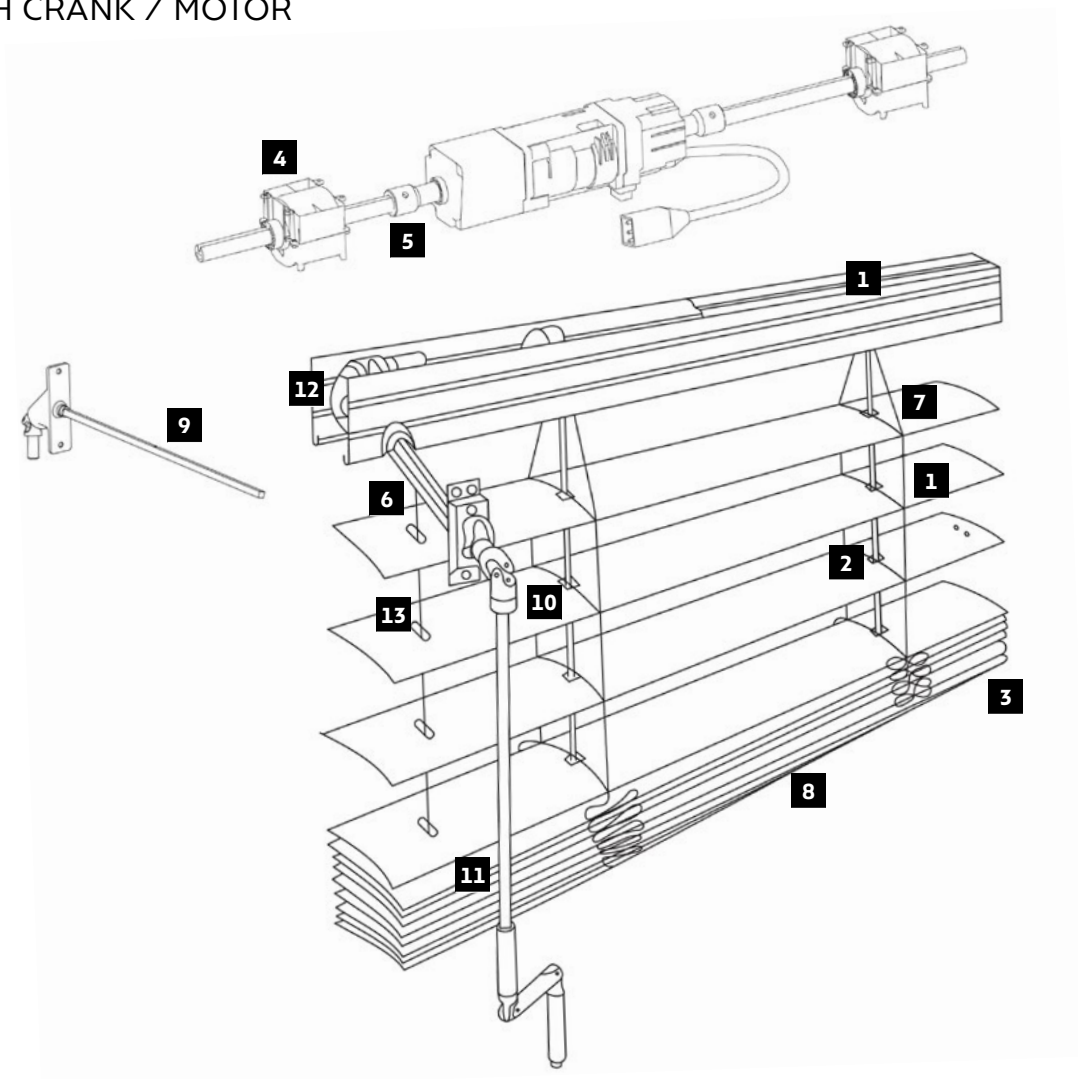

1	Ladder
2	Lifting strap
3	Bottom bar
4	Drum
5	Adaptateur moteur-arbre
6	Guided cable headrail bracket
7	Ladder clip

8	End cap bottom bar
9	90° crank return
10	45° crank return
11	Crank
12	Crank device
13	Câble de guidage

TYPES OF INSTALLATION

OUTDOOR ALUMINUM VENETIAN BLINDS BSO

Screws included

	Wood / Plastic	Aluminium	Concrete / Brick
Ceilling bracket for headrail ST 56x58 <hr/> Wall bracket for headrail EL 40 EL 100	Semi-circular head screw 5x30 galvanized		Semi-circular head screw 5x50 galvanized + peg ø8
Ceilling bracket for headrail ST 40x40 <hr/> Wall bracket for headrail EL 49	Semi-circular head screw 4x25 galvanized		Semi-circular head screw 5x40 galvanized + peg ø8
Ceilling bracket/wall ELC 120 ELC 140 ELC 87 ELCT 100-150 ELCT 150-120	Semi-circular head screw 5x30 galvanized		Semi-circular head screw 5x50 galvanized + peg ø8
Side guides GUP	Flat head screw 3,5x40 stainless steel		Flat head screw 3,5x40 stainless steel + peg ø5
Side guides GUE GUD GAPR GAPCS GAPCD Cable tensioner	Semi-circular head screw 5x25 stainless steel	Screw 4,8x19 stainless steel	Semi-circular head screw 5x40 stainless steel + peg ø10
Crank return	Flat head screw 3,9x22 galvanized		

TYPES OF INSTALLATION

OUTDOOR ALUMINUM VENETIAN BLINDS BSO

Types of installation

In lintel

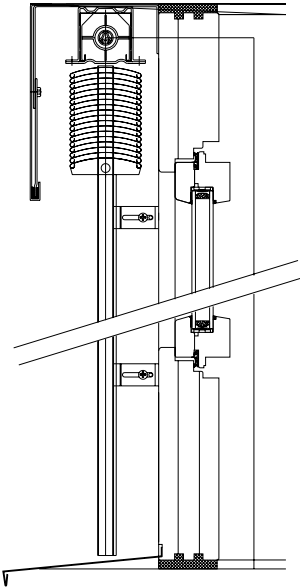

In jambs

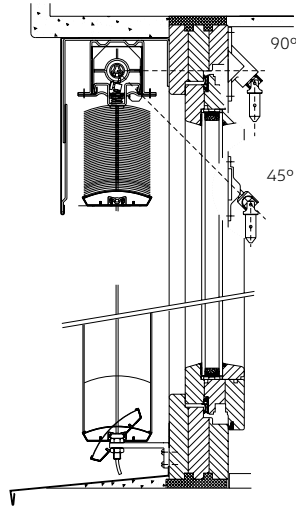

Recessed

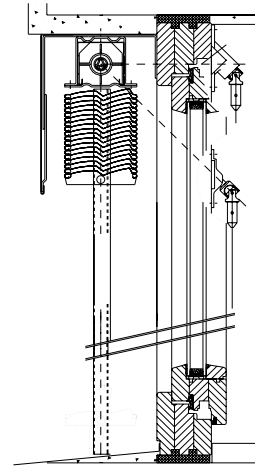

Aligned with the façade

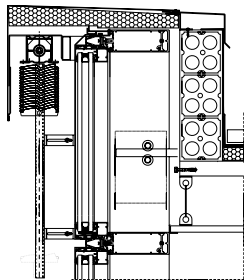

In chamber

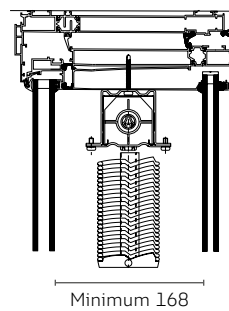

BANDALUX